

# VITALS

КЕРІВНИЦТВО З ЕКСПЛУАТАЦІЇ

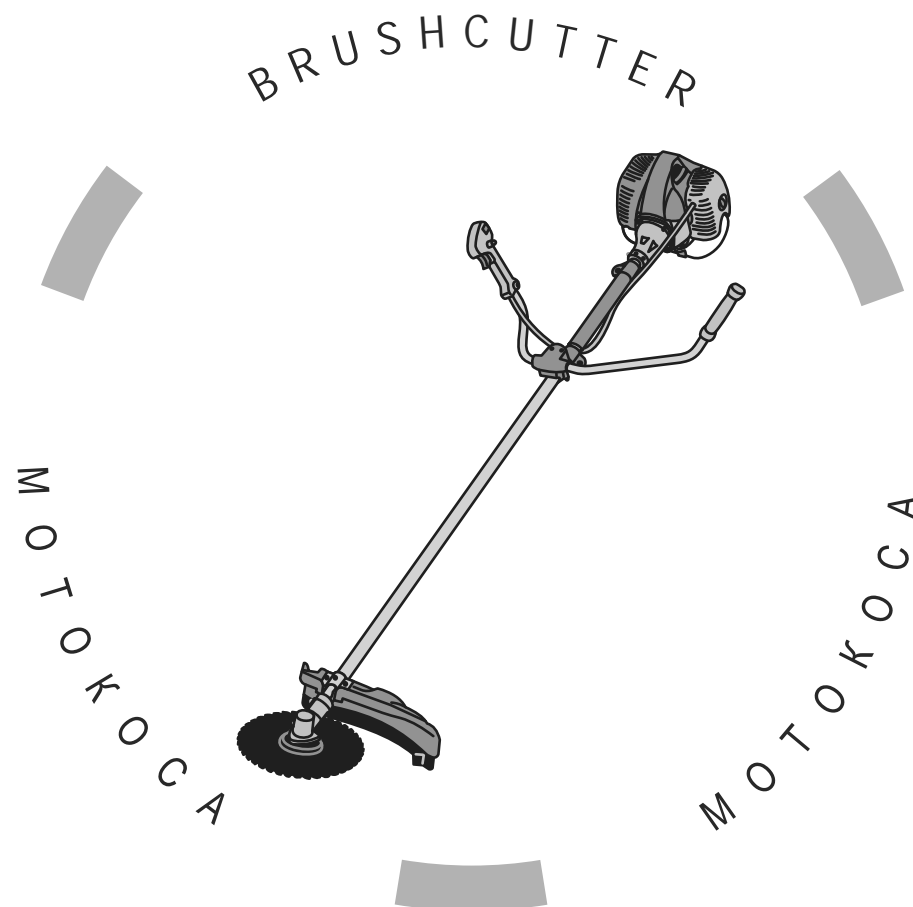

WWW.VITALS.COM.UA



МОДЕЛ

ВК 5223а

ÓÉÐÀ-Í ÑÛÉÁ

- 1.
- 2.
- 3.
- 4.
- 4.1.
- 4.2.
- 5.
- 5.1.
- 5.2.
- 6.
- 7.
- 8.
- 9.



- 6
- 10
- 11
- 12
- 12
- 12
- 17
- 17
- 27
- 31
- 39
- 41
- 43

!

«Vitals».

«Vitals»

«Vitals»

?

?

«  
, 70, . 056-374-89-39.

Vitals Professional BK 5223a

EN 28662-1-2001, ISO 11806:2006.

«  
. 056-374-89-39.

056-374-89-38,

www.vitals.com.ua.

«Vitals».



[Redacted text block]



[Redacted text block]



[Redacted text block]

Vitals Professional BK 5223a

40-

Vitals Professional BK 5223a (

- )

( ,

20

( , , ) .

28

( 4 ) .

« » (

),

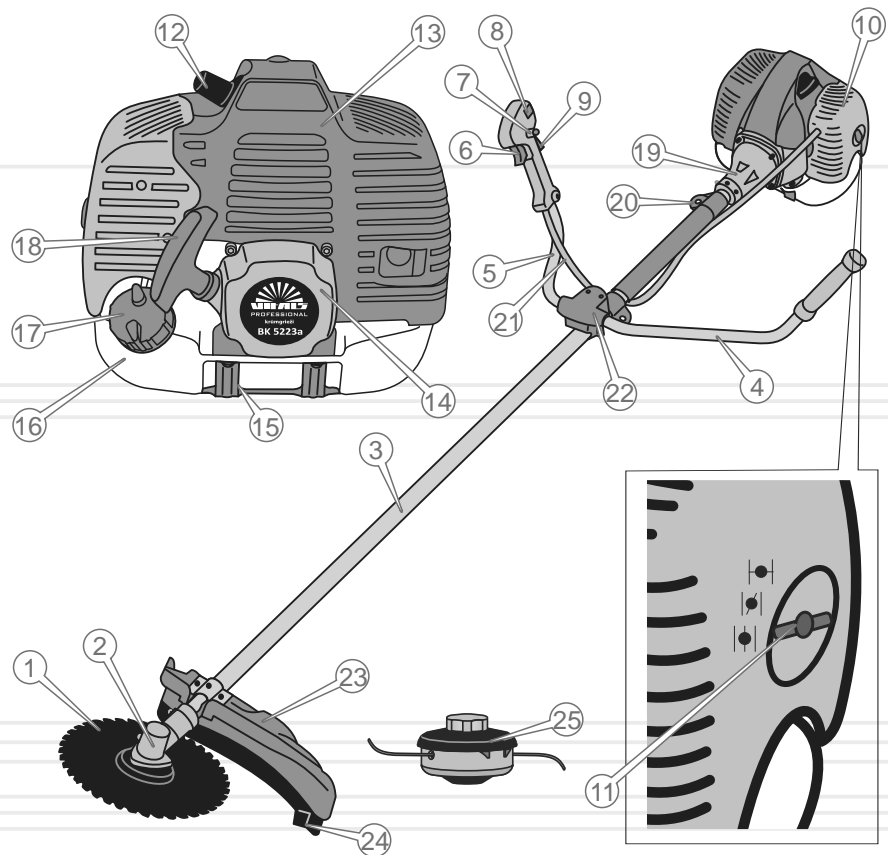

- 1.
- 2.
- 3.
- 4.
- 5.
- 6.
- 7.
- 8.
- 9.
- 10.
- 11.
- 12.
- 13.
- 14.
- 15.
- 16.
- 17.
- 18.
- 19.
- 20.
- 21.
- 22.
- 23.
- 24.
- 25.

2

3

- 1.
- 2.
- 3.
- 4.
- 5.
- 6.
- 7.
- 8.
- 9. 40-
- 10.
- 11.
- 12.
- 13.
- 14.
- 15.

( , , )



! - , -

1

	5223
	25:1
, , 3	52,0
, / . .	2,3/3,1
/ , /	2,9/5000
, /	7500
, ,	1,1
, ,	110
, ,	420
, ,	255
, ,	2,4
, ,	28
	+
	+
	+
	+
	+
	+
	+
	+
	+
( / ),	300 300 300/1530 30 30
/ ,	9,1/9,9

10

11

4.1.

4.

5.

6.



[Redacted text block]

4.2.

1.

2.

16

3.

7.

8.

9.

( 15 )

10.

18.

11.

19.

20.

12.

( 15 )

21.

13.

22.

14.

23.

15.

24.

16.

25.

26.

17.

27.



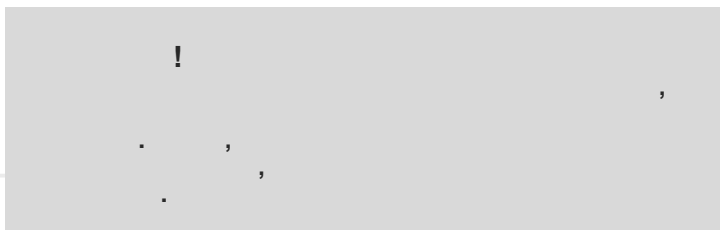

2

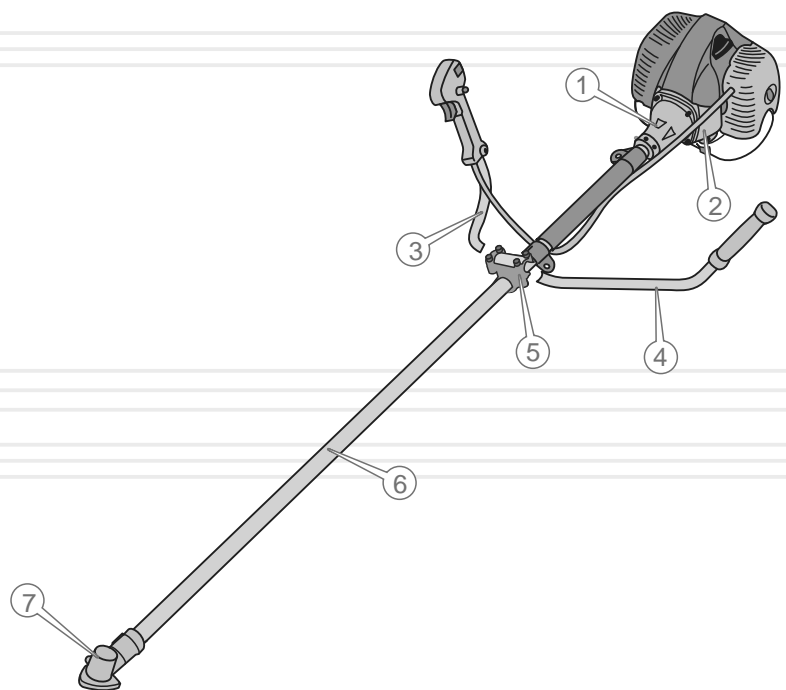

5.1.

- 1. ( 2)
- 2. , ,
- 3. .
- 4. (7) (6).
- 5. 4 5 (1) (6).
- 6. 5 (1) (2)
- 7. 5

1. (5) (3, 4)
2. (3) (4) 2.
- 3.
- 4.

3

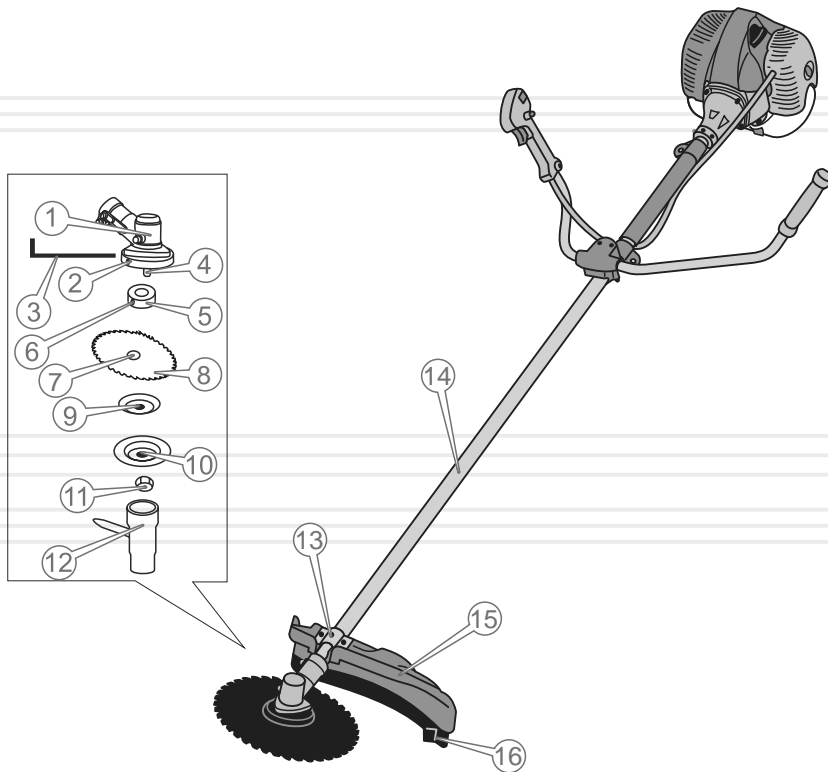

18

1. (16) (15)
2. (3).
3. (14). (13), (15) (13)
4. 8



4.

1. (4) (5) (1) (2) (6)
2. (3), (2) (1)
3. (4) (4) (8) (5)
7. (7)



4. (10), (4) 19 (9), (12), (11).

19



[Redacted text]

- 5. (1) (3) (2)
- 6. .



[Redacted text]

4



[Redacted text]

- 1. (4) (5) (1) (6)
- (2) (4).
- 2. (2) (1)
- 3. (3), (4), (4) (7).
- 4. (4) (8) (9).



[Redacted text]

- 5. (1) (3) (2)
- 6. .



[Redacted text]

- 1.
2. (20)
3. ( ) ( 1).
4. :
- 4



10-20 ( 5).

5



5.



!



!

25:1.

1. , ,
2. (!)
3. (17) ( )
4. 1). 1,1 ( )
5. ).
6. ,
- 
- 
- 
- 
- 

10



[Redacted text block]

- 1. ,
- 2. ( 1). (8) «|»
- 3. 6.

6

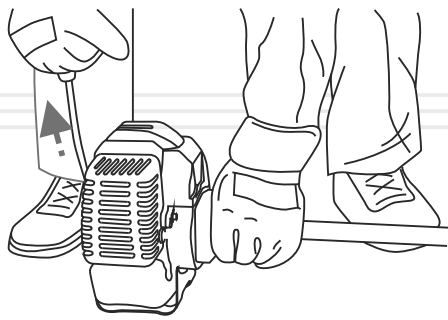

- 4. " ». 3-5  
« », « »,
- 5. (11) ( 1) |.

- 6. (18) ( 1),  
( ) .



[Redacted text block]



[Redacted text block containing '5-10', '8', and '«' symbols]

- 7. , ,
- 8. ,
- 9. (11) ( 1)



[Redacted text block]



[Redacted text block containing '+5°' and '|.' symbols]

+5° .





- 1.
- 2.
- 3.

(15-17 ).  
(24),  
(23) ( 1).



7

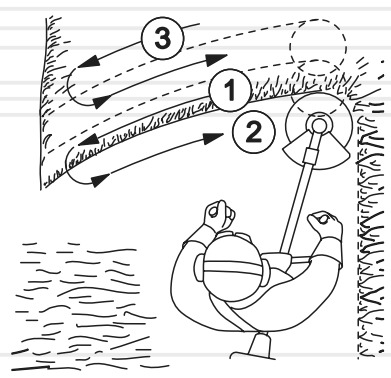

8

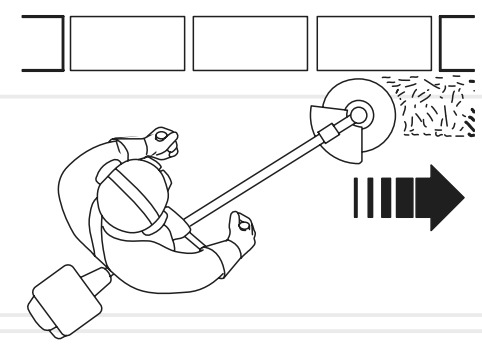

8,

9

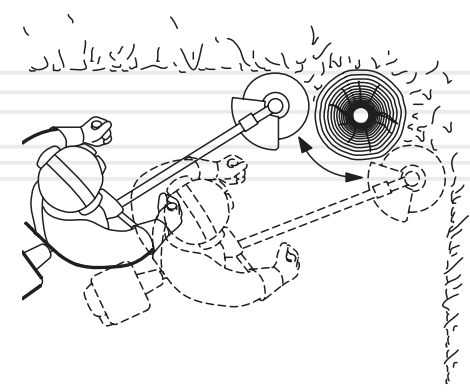

( 9).

20

10

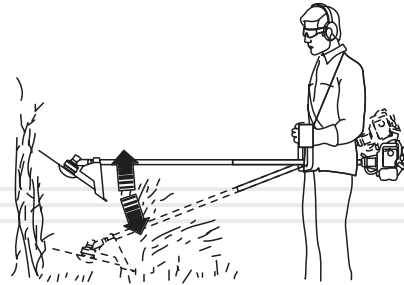

10.



[Redacted text block]



[Redacted text block]



[Redacted text block]



[Redacted text block]



			25	50	100
		•			
		•			
		•			
		•			
		•			
		•			
			•*		
			•*		
		•			
		•			
			•*		
					•*
		•			
		•			
/					
				•*	
					•*
		•			
				•	

\* -

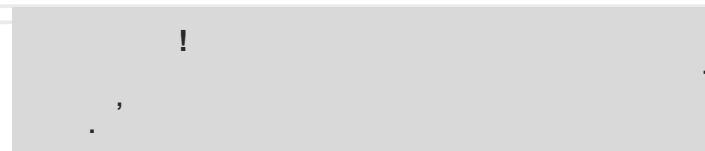

1. ( . 11)
2. ( )
3. ( )
4. (2) (1) ( ) (3)
5. 2,4
6. (4) (3) ( )



11

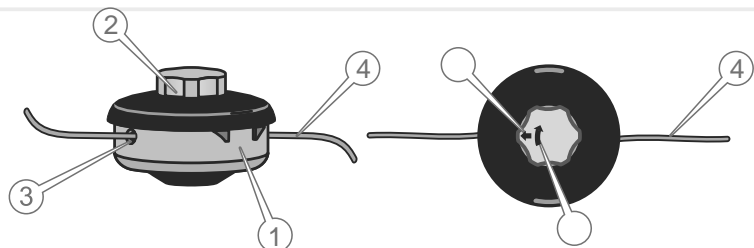

7.

(2)

( ),

15-17



!

0,6 - 0,7

12

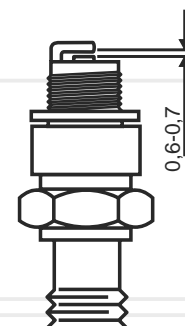

!



!

( 5 )

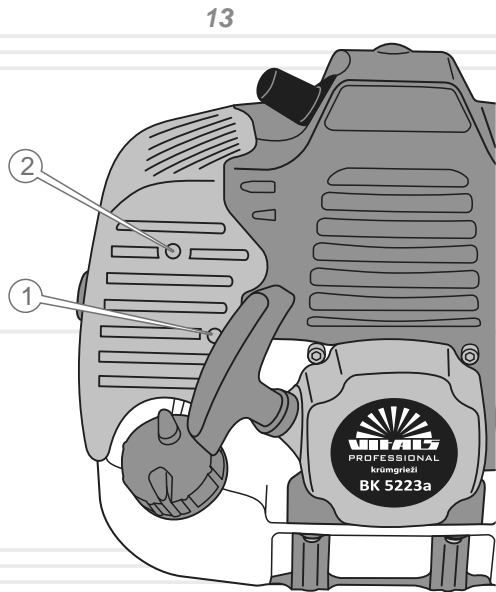

( . 13)

- 1.
- 2.
- 3.
- 4.
- 5.
- 6.

2,5±0,5

13±1

2-5

0,5 ),



!

' 3 , ,



!

25

), (



!

( , 50 ) ,



! [Redacted]



! [Redacted]  
( , )



! [Redacted]



! [Redacted]

« ».

90%.

-15° +55° ,

90%.

-15° +55° ,

- 1.
- 2.
- 3.
- 4.
- 5.



[Redacted text block]

3



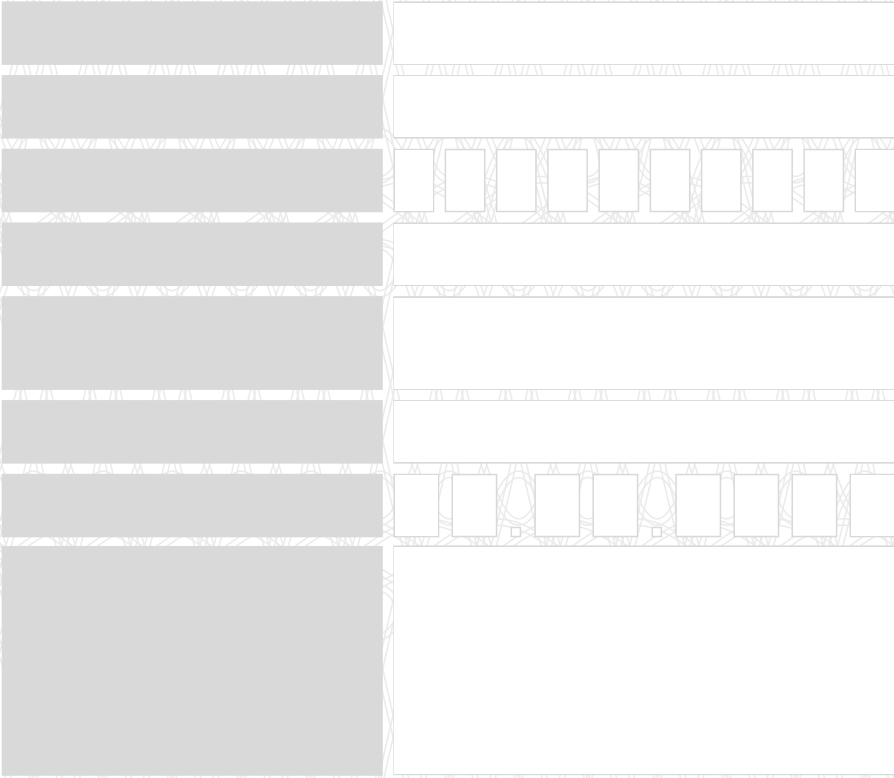

( ):



( ):



( ):



( ):



( ):



( ):

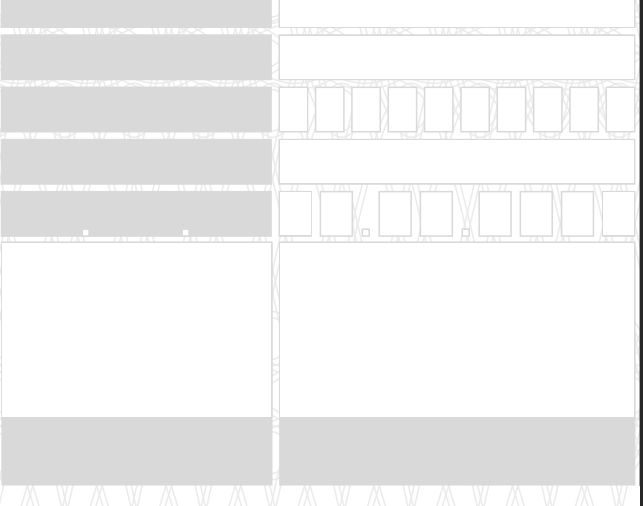
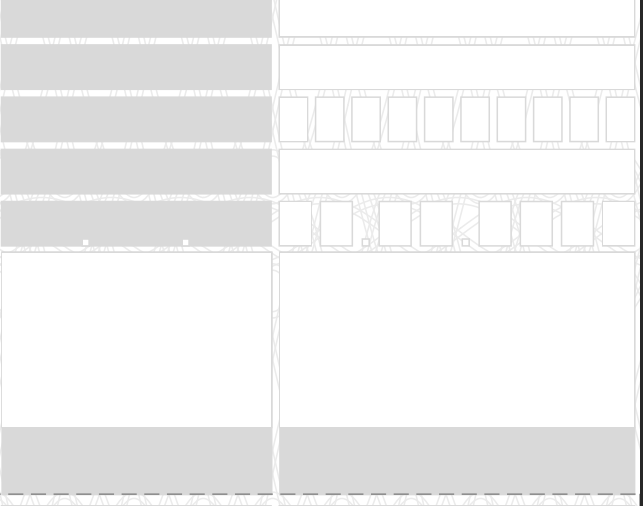
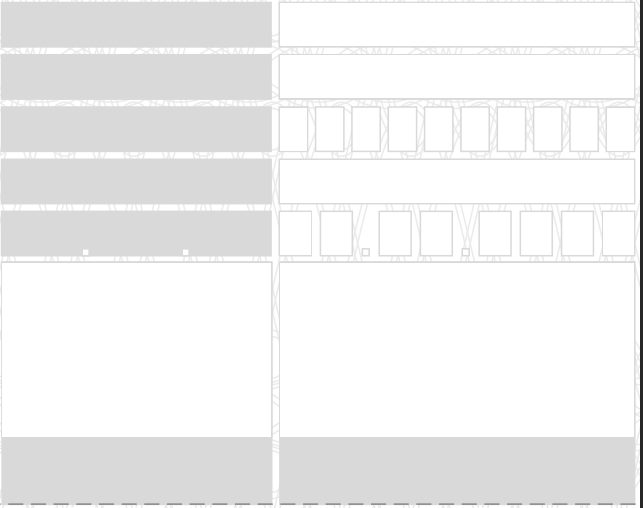

ВІДРИВНИЙ ТАЛОН

ВІДРИВНИЙ ТАЛОН

ВІДРИВНИЙ ТАЛОН



A horizontal form element with a black border. It contains three white rectangular input fields of varying widths, followed by a small square button with a white border. There are small black dots above the first two fields and below the last field.

A horizontal form element with a black border. It contains three white rectangular input fields of varying widths, followed by a small square button with a white border. There are small black dots above the first two fields and below the last field.

A horizontal form element with a black border. It contains three white rectangular input fields of varying widths, followed by a small square button with a white border. There are small black dots above the first two fields and below the last field.



?				

